

NICHIBO DC MOTOR

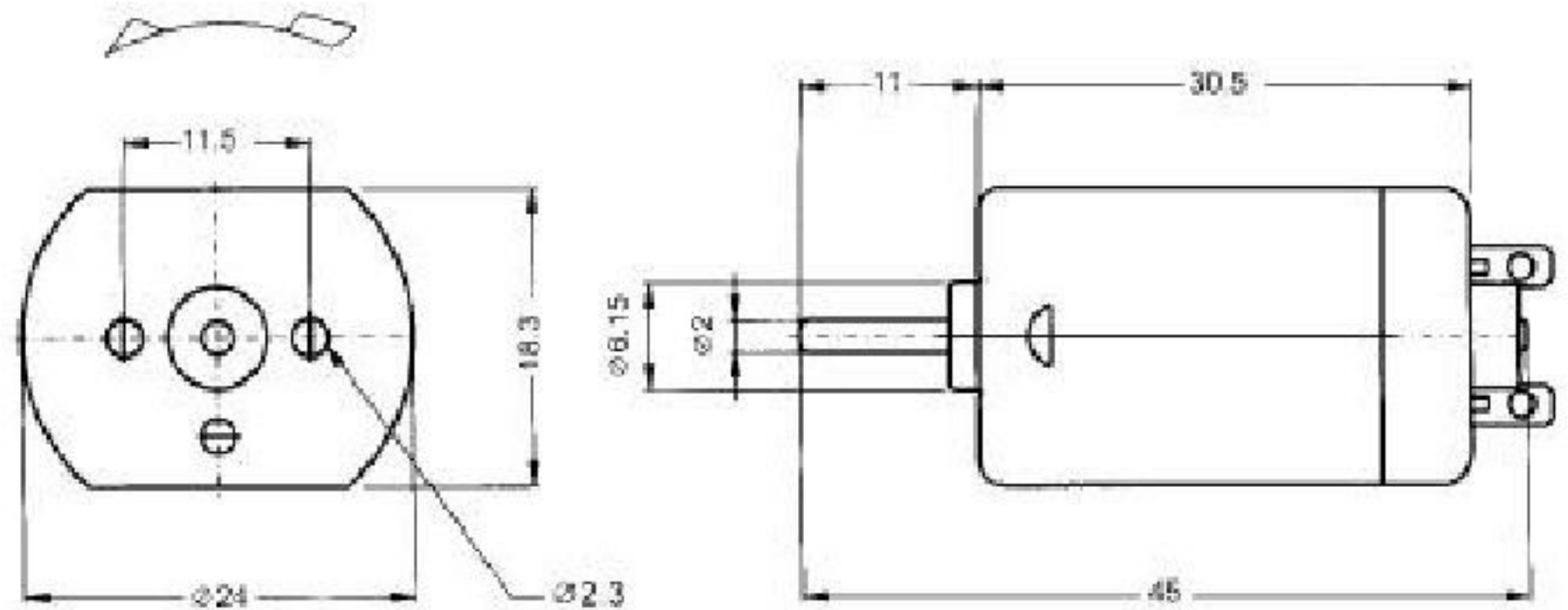

代表的用途：脫毛機
Typical Application : Hair Remover

WEIGHT : 40g(APPROX)

MODEL	VOLTAGE		NO LOAD		AT MAXIMUM EFFICIENCY					STALL	
	OPERATING RANGE	NOMNAL	SPEED	CURRENT	SPEED	CURRENT	TORQUE	OUTPUT	EFF	CURRENT	TORQUE
			rpm	A	rpm	A	g-cm	W	%	A	g-cm
PC-280-20125	3.0 - 9.0	6.0V CONSTANT	10000	0.14	7560	0.57	21.08	1.64	48.55	2.48	117.00
PC-280-16210	3.0 - 12.0	6.0V CONSTANT	6000	0.07	4260	0.28	18.03	0.79	47.56	0.98	81.91
PC-280-15265	6.0 - 12.0	12.0V CONSTANT	10000	0.07	7230	0.30	24.96	1.85	52.52	1.15	119.00
PC-280-10420	6.0 - 24.0	12.0V CONSTANT	6000	0.04	4270	0.13	14.49	0.64	43.59	0.40	62.25

