

RS-365SH



Carbon-brush motors

OUTPUT : 0.7W~35W (APPROX)

WEIGHT : 54g (APPROX)

Typical Applications Home Appliances : Hair Dryer / Massager / Vibrator

MODEL	VOLTAGE		NO LOAD		AT MAXIMUM EFFICIENCY				STALL			
	OPERATING RANGE	NOMINAL	SPEED r/min	CURRENT A	SPEED r/min	CURRENT A	TORQUE mN-m	TORQUE g-cm	OUTPUT W	TORQUE mN-m	TORQUE g-cm	CURRENT A
RS-365SH-2080 (*1)	6~20	18V CONSTANT	19400	0.22	16060	1.06	7.09	72.2	11.9	41.2	420	5.10
RS-365SH-12190 (*2)	12~32	24V CONSTANT	10500	0.080	8430	0.32	5.04	51.4	4.44	25.5	260	1.32

(*1) CCW shifted commutation (CCW+)

(*2) CCW shifted commutation (CCW+), Without vent holes

The terminal position against the tapped holes varies depending on CW+/NEUTRAL.

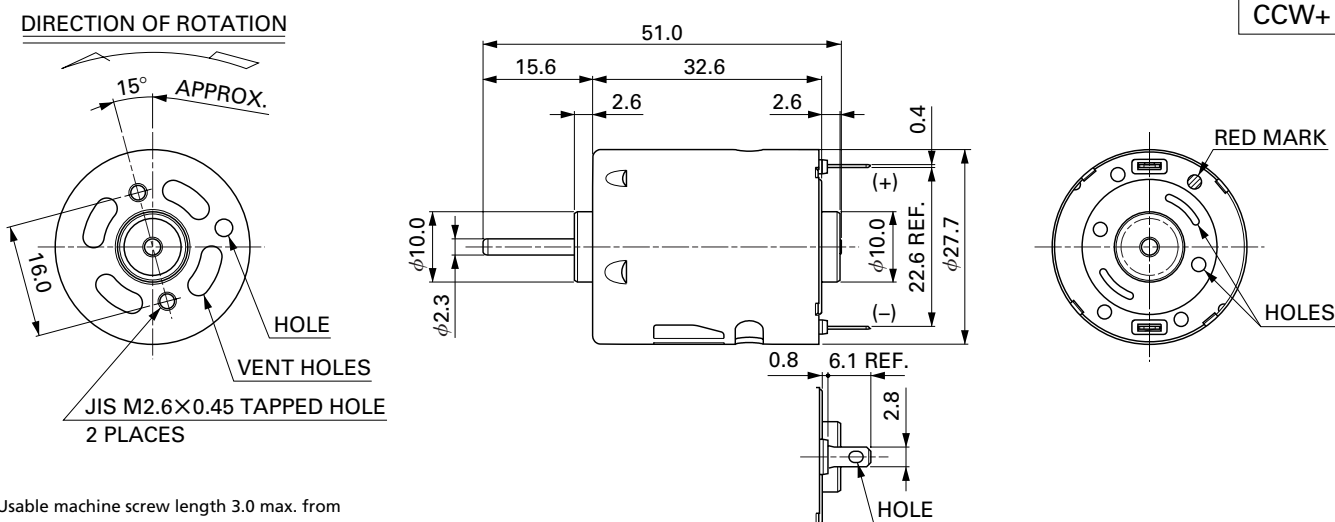

Usable machine screw length 3.0 max. from motor mounting surface.

UNIT: MILLIMETERS

RS-365SH-2080 18.0V

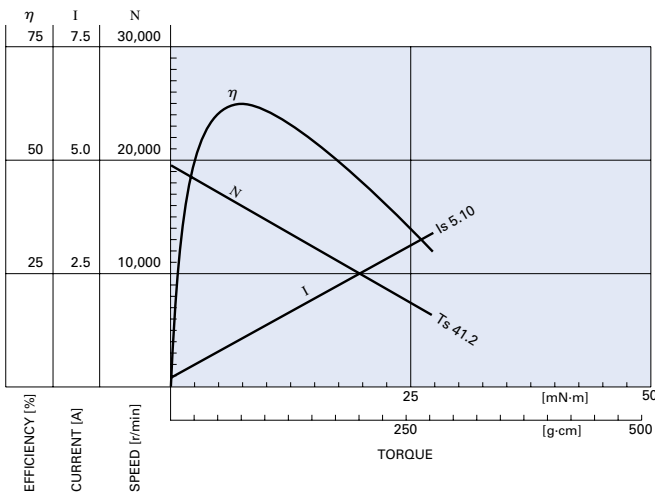

RS-365SH-12190 24.0V

